



Wireless Motion Sensor Stand Anywhere Light

Item # **MB750**



Key Features

- **Motion Sensor Activated:** The Stand Anywhere Light instantly turns on when it detects motion from up to 15 feet away. The light sensor helps to prevent light from activating in daylight.
- **Easy to Install:** No wires and no hardware = easy installation in under 5 minutes; no electrician required.
- **Energy Efficient:** Our high quality LEDs never need to be replaced. It's so efficient, you will get up to one year of battery life.
- **Bright LED:** The LED directs 20 lumens of white neutral light anywhere you need it.
- **Multipurpose:** Versatile and portable standing light for counters, tables and cupboards. Off switch allows for easy travel without wasting battery life.
- **Durable, Weather Resistant:** Tight seals and UV resistant material allow the Mr Beams Stand Anywhere Light to work in all weather conditions.

Light Output	Light Coverage	Batteries
20 Lumens	20 Sq ft	AA <small>4x (not included)</small>
Auto Shut Off	20 Seconds	
Motion Sensing Range	10-15 ft	
Warranty	1 Year	

MR BEAMS®
Surprisingly Bright Light Anywhere

www.mrbeams.com

600 Beta Drive, Unit 100, Mayfield Village, OH 44143

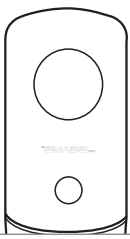

Installation Instructions

Wireless Motion Sensor LED Stand Anywhere Light

MB750

Thank you for purchasing the Mr Beams® Stand Anywhere Light. We are committed to eliminating darkness using the latest in Light-Emitting Diodes (LEDs). LEDs are the most efficient and durable light sources available. We are certain that your light will contribute to a safer environment and provide light where you need it at a very reasonable cost.

What is included per light:

- Wireless LED Stand Anywhere Light

What you need to install:

- 4 AA-Cell Alkaline Batteries (per light)

Stand Anywhere Light Features:

Motion/Light Sensor: Light instantly turns on when it detects motion from up to 15 feet away. The light sensor conserves battery life by preventing the light from activating in daylight.

Auto Shut-off: Stand Anywhere Light shuts off automatically after 20 seconds if no motion is detected.

Bright LED: 20 Lumens covers up to 20 sq ft.

Tips:

- Use only new alkaline AA-Cell batteries with 1.5V rating.
- Do not mix old and new batteries. If batteries are not new, it may cause the light to malfunction.
- Install batteries with polarity in correct position.
- Light may activate when batteries are inserted. Simply take light into a dark room. Allow batteries to settle, then test activation.
- **If your light will not turn off, it means that it is time to replace the batteries.**

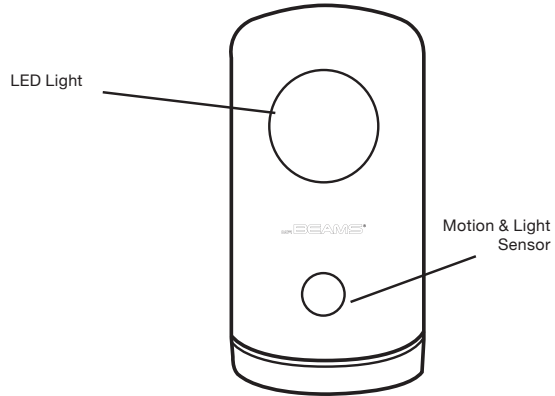

NOTE: Light sensor only allows light to activate in darkness. We recommend you test in a dark room or closet.

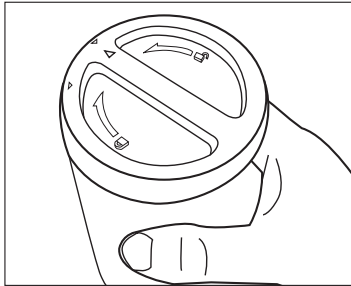

1. To open battery compartment, locate the lid on the bottom of the light.



2. Twist the lid counterclockwise to unlock.

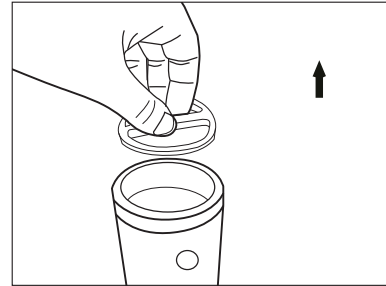

3. Lift the lid off the bottom of the light and use your thumb to open the battery door.

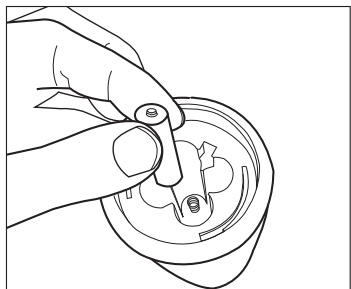

4. Insert 4 AA-cell batteries with correct polarity. Make sure the flat ends of the batteries are against the springs.

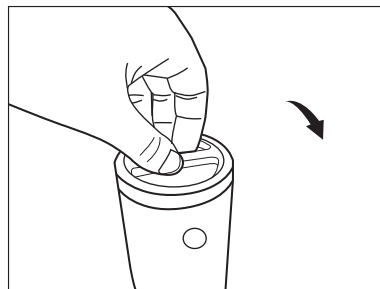

5. Once the batteries have been inserted, replace the lid by lining up the arrows and turning until the arrow is pointing towards the lock symbol.

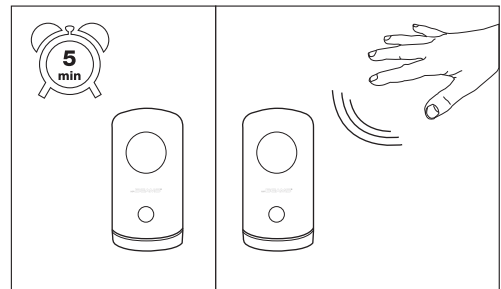

6. Test the motion sensor in a dark closet or bathroom. Leave the light in the dark room for up to 5 minutes. When you re-enter the room, the light should activate with motion.

Battery Caution:

- 1) Do not mix old and new batteries
- 2) Do not mix Alkaline, Standard (Carbon-Zinc) or Rechargeable (Nickel Cadmium) or (Nickel Metal Hydride) batteries
- 3) Do not dispose of batteries in fire
- 4) Batteries should be recycled or disposed of as per state and local guidelines